

1. Introduction

Thank you for your purchase! We appreciate your support.

This document will provide an installation guide for kit K100015 CFMoto UForce 1000 Auxiliary Battery Tray.

2. Kit contents

Kit K100015 includes the following items.

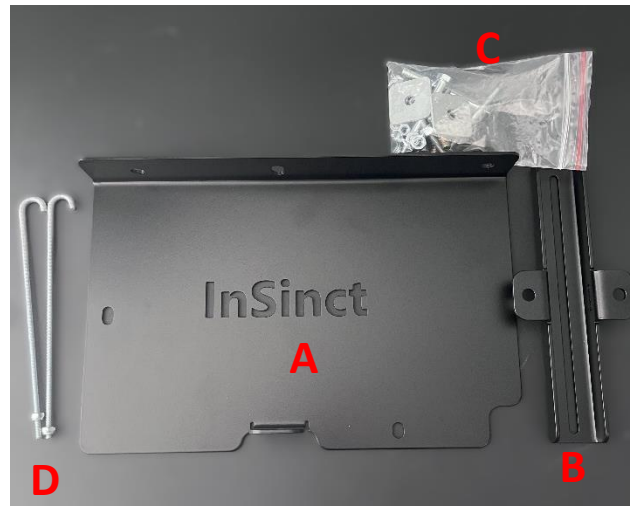

- A. 1 x Battery Tray
- B. 1 x Battery Mount Bracket
- C. 1 x Fastener Kit which includes
 - M8 x 65 Hex Head bolt x 2
 - M8 flat washer x 2
 - Square washer M8 x 2
 - Nyloc nut M8 x 2
 - M6 x 20 button head cap screw x 2
 - M6 x 75 button head cap screw x 1
 - M6 flat washer x 5
 - M6 nyloc nut x 1
 - M6 Flange nut x 2
- D. 2 x Retaining Hooks

3. Installation Guide

It is recommended that the appropriate PPE such as eye protection and gloves are used.

Tools required.

- Hex Key Set
- Set Spanners
- Trim clip remover

1. Remove the passenger side seat, simply pull up on the back section and the seat will pull away. Place it somewhere out of the way.
2. Remove the storage compartment which is located under the seat. Also place this out of the way.
3. Carefully remove the trim clip circled below, once the middle section has been raised it should come out easily. With the trim clip removed, pull the plastic fairing out. Lift the section where the trim clip was, then move the seat belt holder out of the way and pull the fairing toward the middle of the machine.



4. Place the battery tray into position, as pictured below.



5. Install one of the M6x20 button head cap screws into the location circled red above, also using one of the M6 flat washers on the bolt head. Do not tighten yet, just wind it approximately halfway.
6. Install the fastener for the location circled orange above. There are two options for this depending on your machine, see below
 - a. If your machine has a threaded boss in this location like in step 5, simply repeat and install the second M6x20 button head cap screw and M6 flat washer. Wind in approximately halfway
 - b. If your machine does not have a threaded boss here, first remove the bolt underneath the machine which holds the skid plate on. Keep the large washer that you remove, as it will be reused. Next, place the M6 x 75mm button head cap screw with a M6 flat washer through the hole from the top. The thread will poke out at the bottom where you removed the bolt for the skid plate. Now install the larger washer you removed, a M6 flat washer and M6 Nyloc nut. Wind the nut on until the bolt end just protrudes.



7. Install the M8 x 65mm Hex Head Bolts in the locations below, using a M8 flat washer under the bolt head. The bolt will go through the frame cross brace. You may need to reposition the plate to line up the holes, this is why the first bolts were not tightened all the way.



8. Install the M8 square washer and M8 Nyloc nut on the back side of the bolts (see above). If you lift the tray, you can gain access to the backside of the bolts. Tighten these bolts up, as a guide 30-40 N.m.
9. Now, tighten both of the bolts which were initially installed. As a guide for the M6 bolts, 10-15N.m. Check that the battery tray is now firmly secured.
10. Carefully place your battery onto the tray, positioning it in the middle.



11. Place the battery mount bracket on top of your battery (as above). Note, this is designed to work with maintenance free batteries that have a flat top. If you battery is not maintenance free, you may need to install some spacing blocks to clear the battery fill points.
12. Install the retaining hooks so that hook section picks up the hook receiver in the battery tray. Note, the retaining hooks have been designed with extra length to allow for a large range of battery sizes, if they are too long for installation, you can cut them down to size. Wind the M6 flange nut onto the retaining hook to the height desired and cut the waste section away. Use an anti-corrosive coating over the cut surface.
13. Once happy with the retaining hook length, install the M6 flat washer and M6 flange nut. Tighten to approximately 10-15 N.m. Check that the battery is now firmly secured.
14. Reinstall the plastic fairing, storage container and seat.
15. It is recommended after 1-2 hrs of use to re-torque and check that all of the fasteners are secure.

Disclaimer: InSinct provides the battery mounting tray only. Any electrical wiring or installation of the battery is not the responsibility of InSinct. It is recommended that all electrical work be performed by a qualified professional

Follow us on our socials to stay up to date with the latest product releases, offroad content and promotions.



[i_n_s_i_n_c_t](https://www.instagram.com/in_sinct)



[InSinctOffroad](https://www.youtube.com/InSinctOffroad)



[InSinct](https://www.facebook.com/InSinct)